

DS-KD-ACF3
Accessory Package

104-928F3

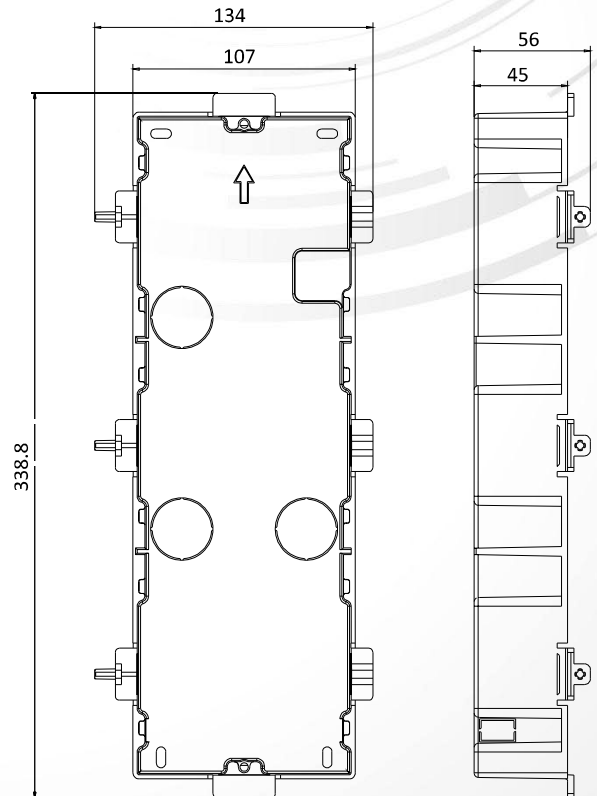

Dimension



Unit:mm

Key Feature

- Contains gang box, cover screws, lines, etc.
- Adapts to three-module flush mounting.

Specification

Parameters	Cover	Gang Box
Material	Aviation Aluminum	Plastic
Working temperature	-40° C to +55° C (-40° F to 131° F)	
Working humidity	10% to 95%	
Dimension	337.8 × 124 × 4 mm (13.3" × 4.88" × 0.16")	338.8 × 134 × 56 mm (13.33" × 5.31" × 2.20")
Weight	784 g (with packaging) 420 g (without packaging)	

ORDERING INFORMATION

104-928F3

Hikvision DS-KD-ACF3